

FAST-LOCK COUPLING SYSTEM F 30 VALVE NIPPLES FVN30

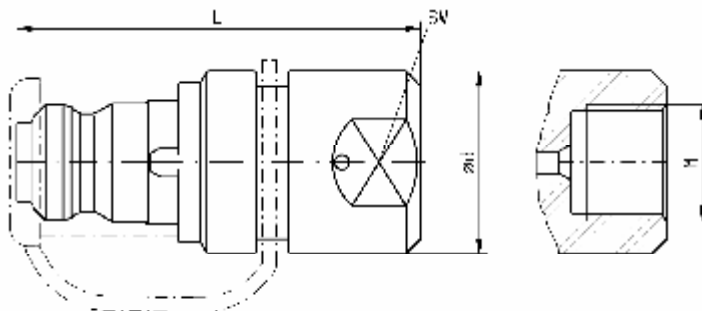

TECHNICAL DATA:

Article number	1-06000-0002	1-06000-0004
connection	inside thread	
sealing method	60° cone	
thread size M	M16x1,5	M20x1,5
hexagon SW	22 mm	27 mm
max. tight. torque	40 Nm	70 Nm
length L	55 mm	59 mm
diameter	25 mm	30 mm
weight	0,13 kg	0,16 kg

Further designs and connections are available upon request.

Open nipples and turnable elbow connectors see separate data sheets.

General technical data see summary data sheet 1-06000

CAUTION! Always take care of the max. working pressure of the connected components!

ORDER DENOMINATION

„fast-lock nipple FVN30, *Art.-Nr. 1-06000-XXXX*“

The last 4 digits define connection type and size e.g. M16x1,5 IG: 1-06000-0004.

DELIVERY STATE:

Completely assembled and tested, incl dust cap

The coupling nipples are made for use with hydraulic oil. Please ask for other fluids.

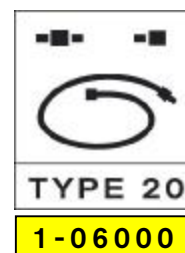

FASTEC AG
INDUSTRIEZONE
SCHÄCHENWALD
CH-6460 ALTDORF
SWITZERLAND

FON +41 41 875 78 30
FAX +41 41 875 78 31
INFO@FASTEC.CH
WWW.FASTEC.CH